

Training and Customer Service Centre BOMAG

Boppard, 2011
Office/administration buildings

The new training and customer service centre is a natural, elongated two to three-storey structure situated on the Kratzenburger Landstrasse. It nestles into the contours of the rocky site, slotting effortlessly into the sloping landscape. To the southeast the magnificent landscape extends towards the hillside forest and in the northwest the covered grandstand offers striking views over the demonstration area below. The entrance, together with the future deliveries access point, is located at the crossroads of an ancient Roman road, where the Kratzenburger Landstraße branches off, and will serve as a new site address for BOMAG. A drop-off point will be located at the same level as the visitors' entrance, with staff and visitor parking on the floor below, naturally integrated into the falling topography of the site. This will also serve as the delivery point for the exhibition and workshop areas, keeping the traffic flow naturally separated. The entire perimeter of the building is vehicle accessible e.g. in case of fire.

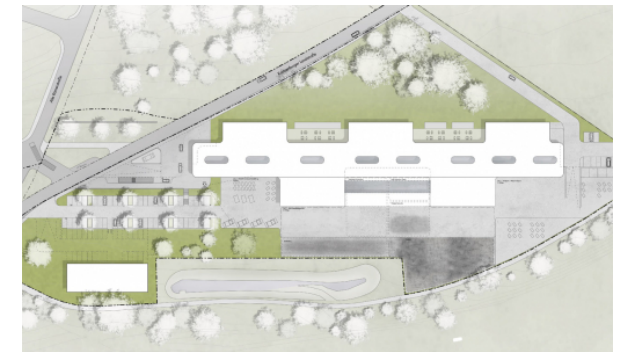

Training and Customer Service Centre BOMAG

Boppard, 2011
Office/administration buildings

Technical details:

Typology: Office/administration buildings
Procurement documentation: Competition
Service phases (HOAI): 1

